

Dorplan

Harmonising Doors & Ironmongery

Pura Pocket +

With provision
for electrical
containment

sales@dorplan.co.uk

01366 386800

www.dorplan.co.uk



PuraPocket + Provision for electrical containment



Dorplan
Harmonising Doors & Ironmongery

Single leaf
For plasterboard partition walls

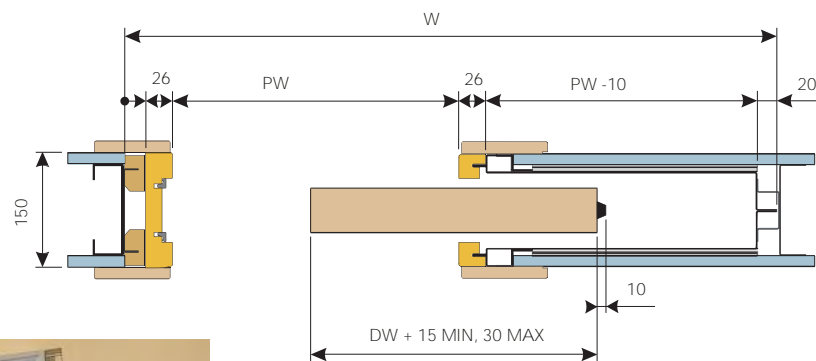
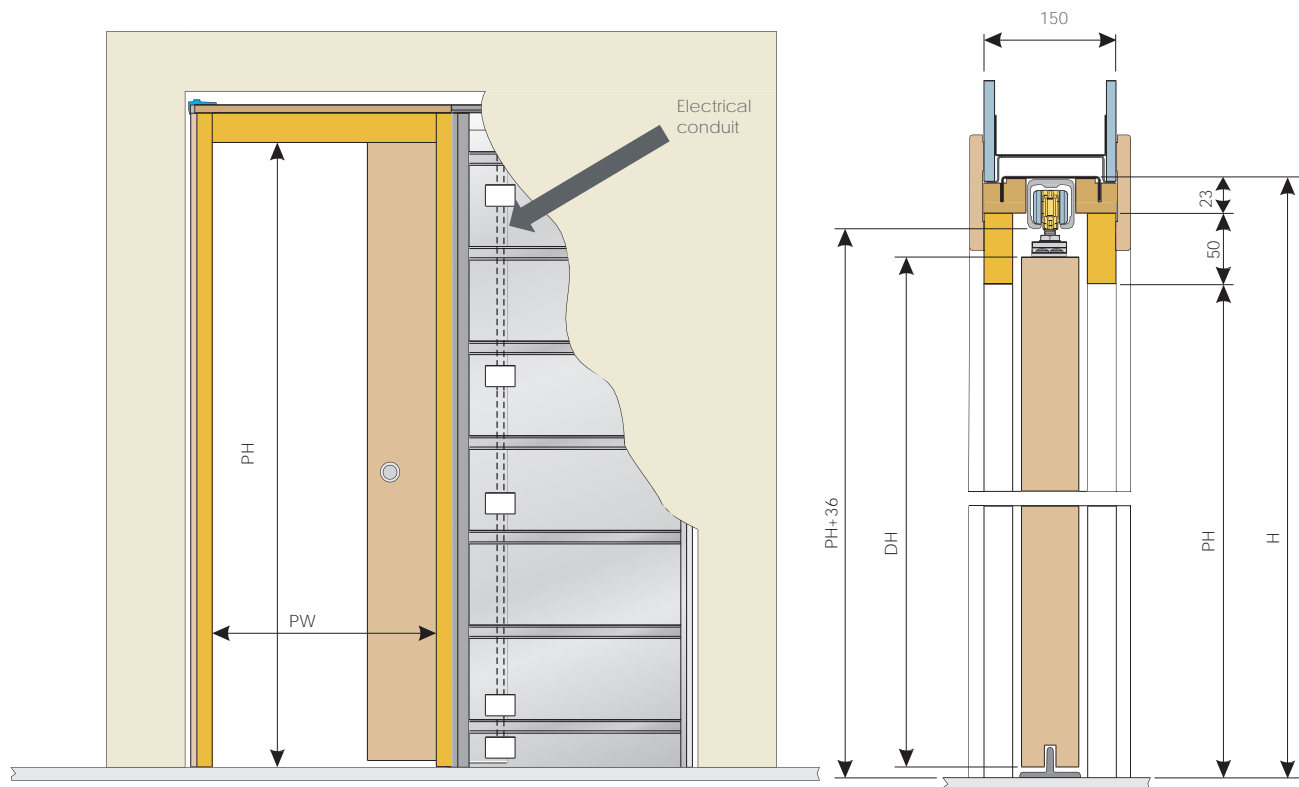

Notes

- Suitable for 44mm thick doors.
- Max door weight 80kg
- All dimensions given in mm
- Full range of complimentary accessories available – See page 17 onwards
- NB: Non-standard sizes are available**

Max Passage Size PW x PH	Structural Opening W x H	Door Size DW x DH	Wall Thickness	Product Code
600 x 2030	1325 x 2135	626 x 2040	150	90130/A
700 x 2030	1525 x 2135	726 x 2040	150	90130/B
800 x 2030	1725 x 2135	826 x 2040	150	90130/C
900 x 2030	1925 x 2135	926 x 2040	150	90130/D
1000 x 2030	2125 x 2135	1026 x 2040	150	90130/E
650 x 1970	1425 x 2075	686 x 1981	150	90130/F
740 x 1970	1625 x 2075	762 x 1981	150	90130/G
800 x 1970	1725 x 2075	838 x 1981	150	90130/H
890 x 1970	1925 x 2075	914 x 1981	150	90130/I

Doors can be removed for maintenance or repair without damage to the surrounding walls



PuraPocket + Provision for electrical containment

Double leaf
For plasterboard partition walls

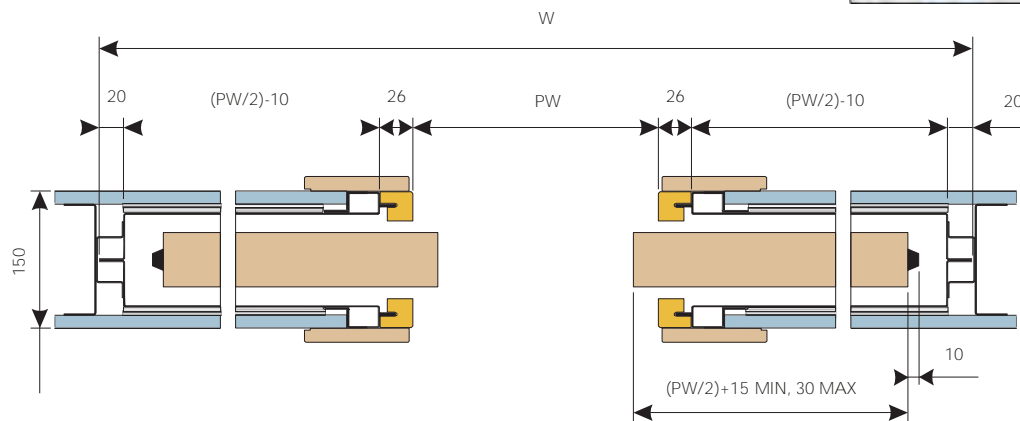
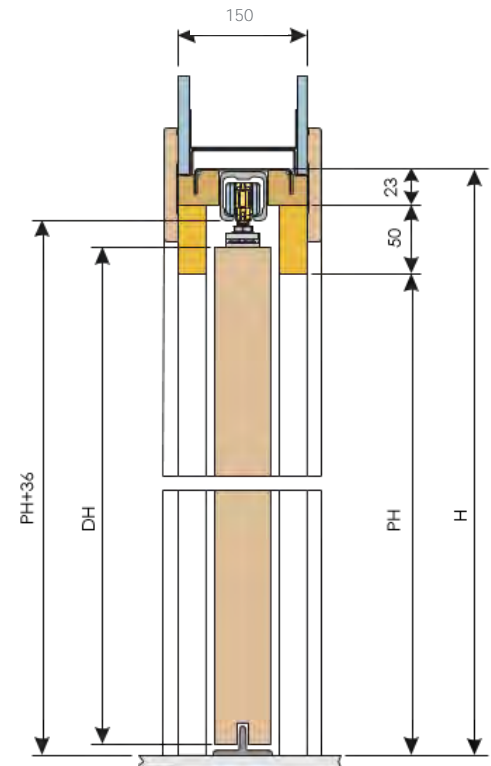
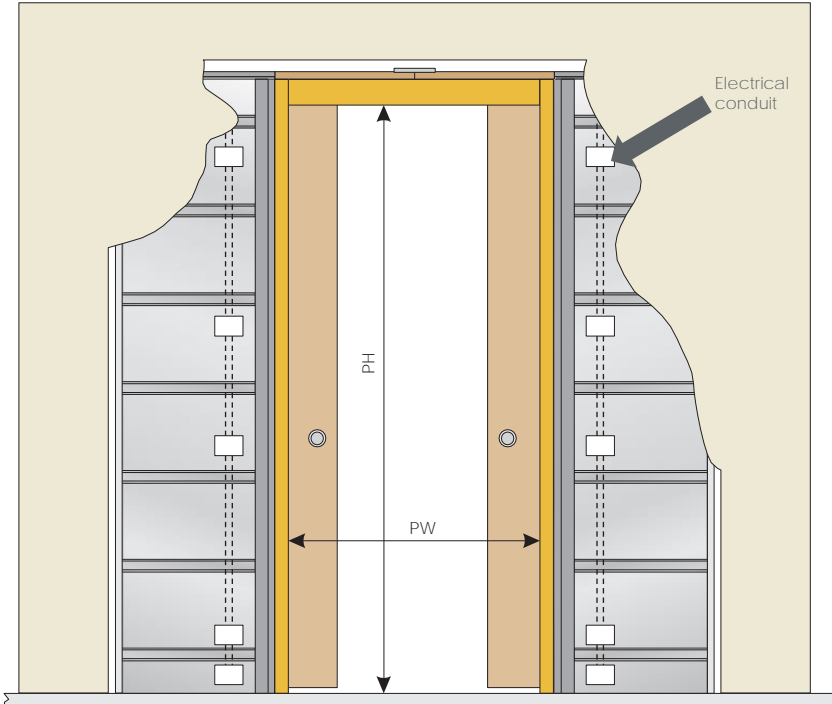

Notes

- Suitable for 44mm thick doors.
- Max door weight 80kg
- All dimensions given in mm
- Full range of complimentary accessories available - See page 17 onwards
- NB: Non-standard sizes are available**

Max Passage Size PW x PH	Structural Opening W x H	Door Size DW x DH	Wall Thickness	Product Code
1200 x 2030	2650 x 2135	626 x 2040	150	90135/A
1400 x 2030	3050 x 2135	726 x 2040	150	90135/B
1600 x 2030	3450 x 2135	826 x 2040	150	90135/C
1800 x 2030	3850 x 2135	926 x 2040	150	90135/D
2000 x 2030	4250 x 2135	1026 x 2040	150	90135/E
1300 x 1970	2850 x 2075	686 x 1981	150	90135/F
1480 x 1970	3250 x 2075	762 x 1981	150	90135/G
1600 x 1970	3450 x 2075	838 x 1981	150	90135/H
1780 x 1970	3850 x 2075	914 x 1981	150	90135/I

Doors can be removed for maintenance or repair without damage to the surrounding walls